

# EasyTouch<sup>®</sup>

## Wireless Wall Switch



Forest Link RF  
Protocol inside

## TABLE OF CONTENTS

<b>1. General</b>	<b>3</b>
1.1. Specifications	3
<b>2. Contents</b>	<b>4</b>
2.1. Main parts	4
<b>3. Safety</b>	<b>5</b>
3.1. Intended use	5
3.2. Safety instructions	5
<b>4. Installation</b>	<b>6</b>
<b>5. Pairing</b>	<b>7</b>
5.1. Pairing the Shuttle S/M/L or Shuttle ION	7
5.2. Pairing the Shuttle GO	7
5.3. Pairing to a tubular motor	8
<b>6. Use</b>	<b>9</b>
6.1. Normal operation	9
6.2. Setting up the favourite position	9
6.3. Activating child lock / hotel lock	10
<b>7. Troubleshooting</b>	<b>11</b>
<b>8. Conformity</b>	<b>12</b>
<b>9. Liability</b>	<b>13</b>
<b>10. Recycling</b>	<b>13</b>
<b>11. Declaration of conformity</b>	<b>14</b>

## INTRODUCTION

- 3 Thank you for purchasing the Forest EasyTouch® wireless wall switch!
- 4 The EasyTouch® wireless wall switch is a remote control for your Forest devices. With the EasyTouch® you can operate up to two Forest devices.

EN



Forest Link RF  
Protocol inside

The EasyTouch® wireless wall switch is equipped with both the original RF protocol and the new Forest Link® protocol as standard.

# 1. General

Read this manual and the safety instructions carefully before using this Forest Group product. Follow the instructions in this manual and keep it throughout the entire lifespan of the product. This manual describes the installation and operation of the EasyTouch® wireless wall switch.

Any use beyond the application scope defined by Forest Group is not permitted. Ignoring the instructions in this manual voids any liability and warranty from Forest Group.

EN

The EasyTouch® wireless wall switch features:

- Two-channel control
- Low-battery alert
- Equipped with Forest Link RF protocol
- Also compatible with the original RF protocol
- 5 Year warranty

## 1.1. SPECIFICATIONS

Specifications	Value
Max. transmit range	30 m
Max. transmit power	< 0 dBm (ERP)
Frequency	433 MHz ± 100 KHz
Battery	2× 1.5V LR03 (2× AAA battery)
Radiocoding	Original Forest Protocol
	Forest Link Protocol
Dimensions	83 × 83 × 19 mm
Weight (incl. 2× AAA battery)	90 g
Weight (excl. 2× AAA battery)	66 g
Working temperature	0°C - 50°C

## 2. Contents

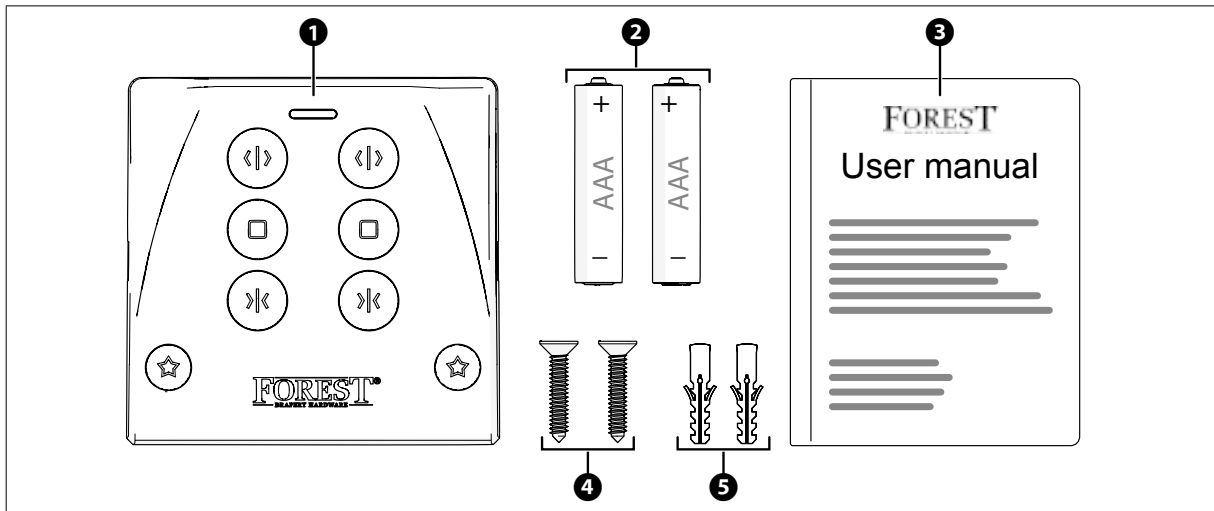





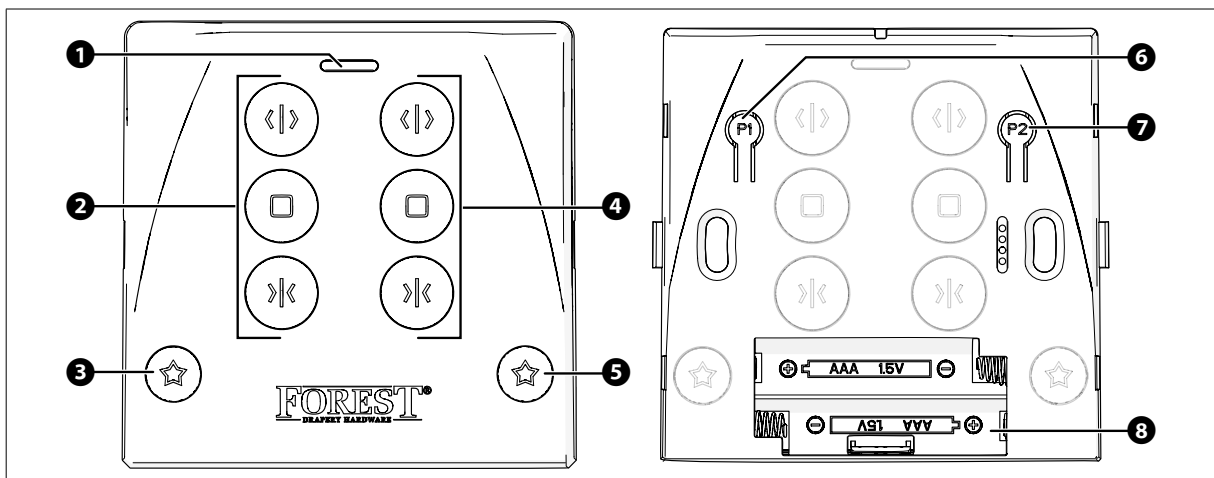

- ❶ 1× EasyTouch® wireless wall switch
- ❷ 2× AAA batteries
- ❸ 1× User manual
- ❹ 2× Screws (3×20mm)
- ❺ 2× Plastic wall plugs

### 2.1. MAIN PARTS

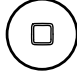

- ❶ LED indicator
- ❷ Buttons channel 1
- ❸ Favourite button channel 1
- ❹ Buttons channel 2
- ❺ Favourite button channel 2
- ❻ Program button channel 1
- ❼ Program button channel 2
- ❽ Battery compartment

## Buttons functionality

Button	Function	Button	Function
	Press to <b>open</b> the curtains or to switch <b>on</b> the LED lighting.		Press to access your favourite curtain position. <sup>1</sup>
	Press to <b>close</b> the curtains or to switch <b>off</b> the LED lighting.		Used in programming of the functions. <sup>2</sup>
	Press to <b>stop</b> the moving curtains or to <b>dim</b> the LED lighting.		

<sup>1</sup> Only available on motors with Forest Link protocol.

<sup>2</sup> See the motor's user manual for more information.

EN

## 3. Safety

### 3.1. INTENDED USE

- This product is intended as a wall mounted wireless remote control for use with motorised Forest systems.
- This appliance is not intended for use by persons (including children) with reduced physical, sensory or mental capabilities, or lack of experience and knowledge, unless they have been given supervision or instruction concerning use of the appliance by a person responsible for their safety.
- This product is only intended for indoor use.

### 3.2. SAFETY INSTRUCTIONS

#### ⚠ WARNING

- Always read and understand this manual and keep this document close to the product at all times. Go to [www.forestgroup.com](http://www.forestgroup.com) for the online version of the user manual.
- Children should not be near the installation of the wall switch on the installation location.
- Children should be supervised to ensure that they do not play with the appliance.
- Do not dismantle, open, or shred batteries. Chemicals inside the batteries can combust upon contact with ambient air.
- Seek medical advice immediately if battery has been swallowed.

#### ⚠ CAUTION

- Do not expose the device to high temperatures or place it in direct sunlight.
- This product is for indoor use only, do not use in outdoor or in humid environments, such as bathrooms or swimming pools.
- Do not subject batteries to mechanical shock.
- In the event of a battery leaking, do not allow the liquid to come in contact with the skin or eyes. If contact has been made, wash the affected area with copious amounts of water and seek medical advice.
- Battery usage by children should be supervised at all times.
- Do not subject batteries to heat or fire. Avoid storage in direct sunlight.
- Only use AAA batteries as described in this manual.

#### NOTICE

- Never immerse the device in liquid.
- Do not drop the device, drill holes in it, or disassemble it, as this will void the warranty.
- Ensure that the plus (+) and minus (-) poles are inserted correctly to avoid a short circuit.
- Always keep batteries clean and dry.
- Always use new or fully charged batteries for optimal product performance.

## 4. Installation

1. Use a flathead screwdriver to carefully remove the **front cover** from the product.

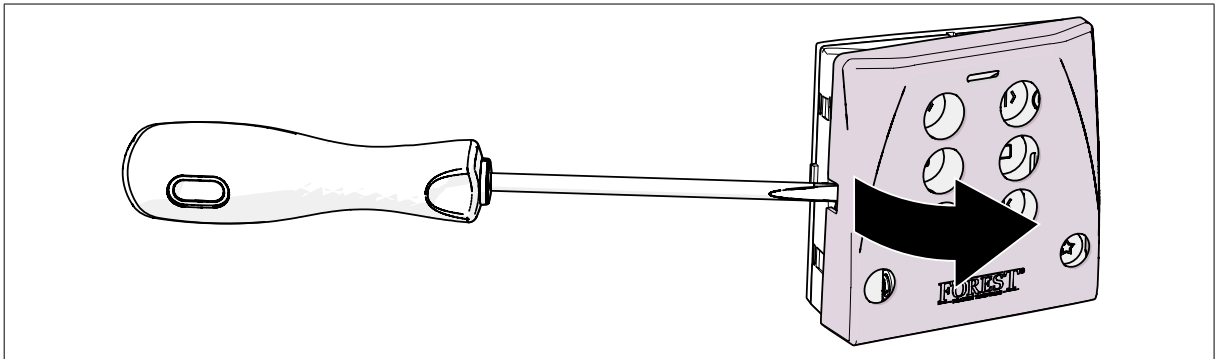

EN

2. Use the screw holes as a template to **mark** your drilling location.
3. Use an electric drill and 4 mm masonry drill bit to **drill** the two mounting holes.
4. Insert the included **plastic plugs** in the two holes.
5. Use a cross-head screwdriver and the two included screws to **mount** the product to the wall.

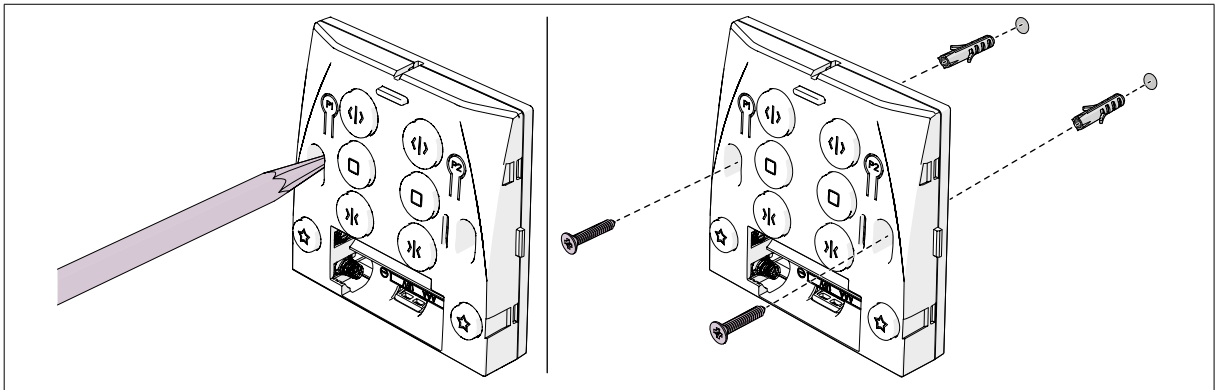

6. Insert the **2× AAA batteries** into the battery compartment.  
**i** Ensure that the plus (+) and minus (-) poles are inserted correctly to avoid a short circuit.
7. Click the **front cover** back on the product.

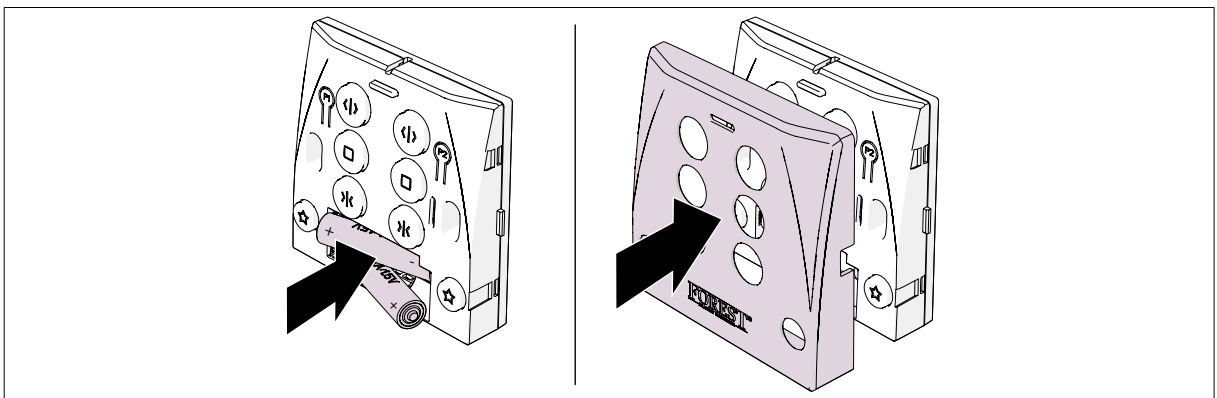

## 5. Pairing

The remote control needs to be paired with the Forest Shuttle before it can be operated.

- ❗ Pairing cannot be done under group channel or 0 (all) channel.

### 5.1. PAIRING THE SHUTTLE S/M/L OR SHUTTLE ION

1. Use a pen to press the **P button** on the Shuttle 3 times.

The LED indicator scrolls from the first, to the second, and finally the third LED.

2. Press and hold the **P button** a 4th time, for 5 seconds.

The LED indicator on the motor flashes green.

3. Within 10 seconds, press the **Open channel 1** or **Open channel 2** button to pair the Shuttle to the remote.

The green LED indicator on the motor switches off, indicating the remote is paired to the Shuttle.

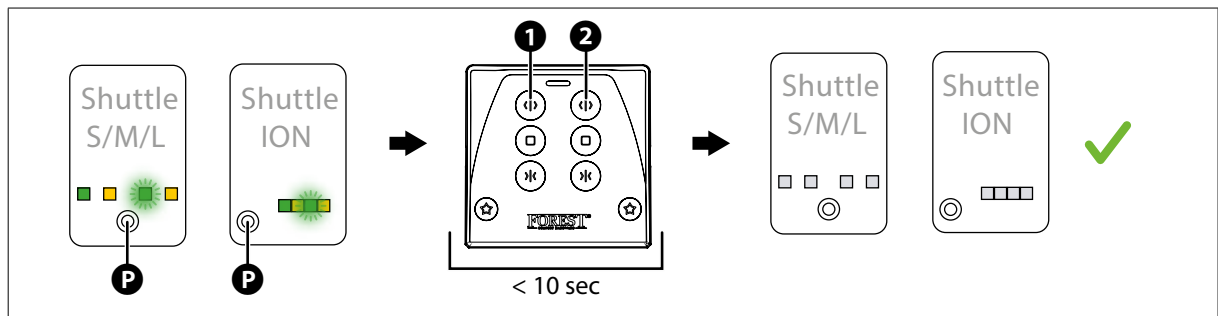

### 5.2. PAIRING THE SHUTTLE GO

1. Press the **P button** on the Shuttle 3 times.

The LED indicator on the motor is orange.

2. Press and hold the **P button** a 4th time, for 5 seconds.

The LED indicator on the motor flashes orange.

3. Within 10 seconds, press the **Open channel 1** or **Open channel 2** button to pair the Shuttle to the remote.

The curtains move, indicating the remote is paired to the Shuttle.

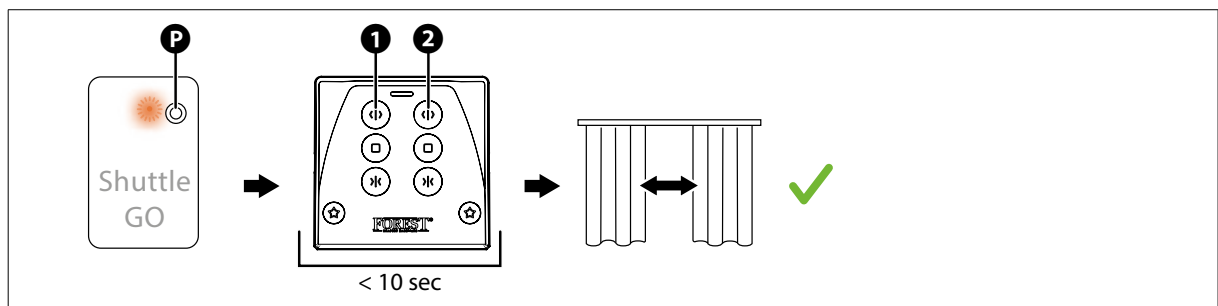

### 5.3. PAIRING TO A TUBULAR MOTOR

To pair the product to a Forest tubular motor, see the user manual of the respective tubular motor for more information.

Alternatively, go to the following link or scan the QR code to visit the Forest webpage with all user manuals: [www.forestgroup.com/en/downloads/technical-documents](http://www.forestgroup.com/en/downloads/technical-documents)



EN



## 6. Use

### 6.1. NORMAL OPERATION

1. Press the **Open button** to open the curtains.
2. Press the **Stop button** to stop the curtains at any desired location.
3. Press the **Close button** to close the curtains.

### 6.2. SETTING UP THE FAVOURITE POSITION

The favourites buttons allow you to set a custom curtain position for each motor. Pressing the button(s) moves the curtain automatically to the specified position.

EN

**i** The favourite position can only be set up if the end positions of the motors are configured. This only works for motors with Forest Link protocol.

1. Use the **Open**, **Close**, and/or **Stop buttons** to move the curtains to the desired favourite position.
  2. Press and hold the **Favourites** and **Stop button** for 2 seconds to set up the current position as the favourite.
  3. Press the **Favourite button** from any position to move the curtains to the favourite location.
- i** Only one favourite location can be saved per motor.

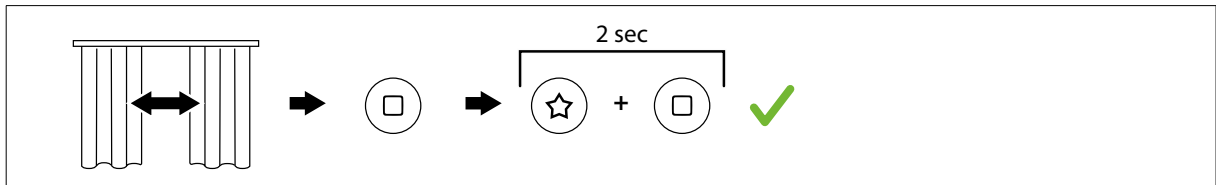

To remove the favourite position:

1. Press the **Favourite button** from any location to move the curtains to the favourite location.
2. Press and hold the **Favourite** and **Stop button** for 2 seconds to remove the current position as the favourite.

The favourite location is now removed.

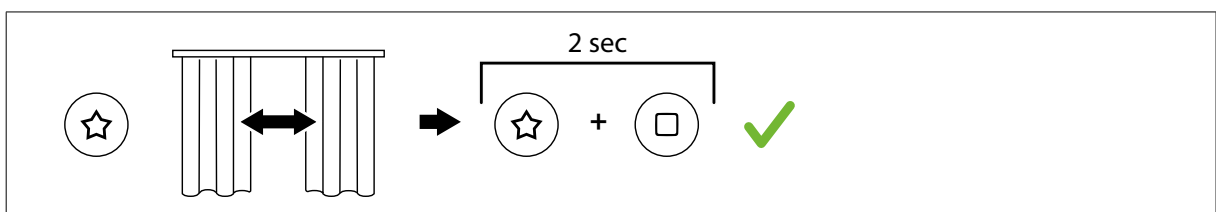

### 6.3. ACTIVATING CHILD LOCK / HOTEL LOCK

With child lock / hotel lock activated, the dual button functions (such as setting up Favourites) are disabled.

1. Use a flathead screwdriver to carefully remove the **front cover** from the product.
2. Press and hold the **Program button channel 1** or **Program button channel 2 buttons** for 10 seconds.

The child lock / hotel lock is now activated.

- ⓘ Wait at least 30 seconds before sending other commands.

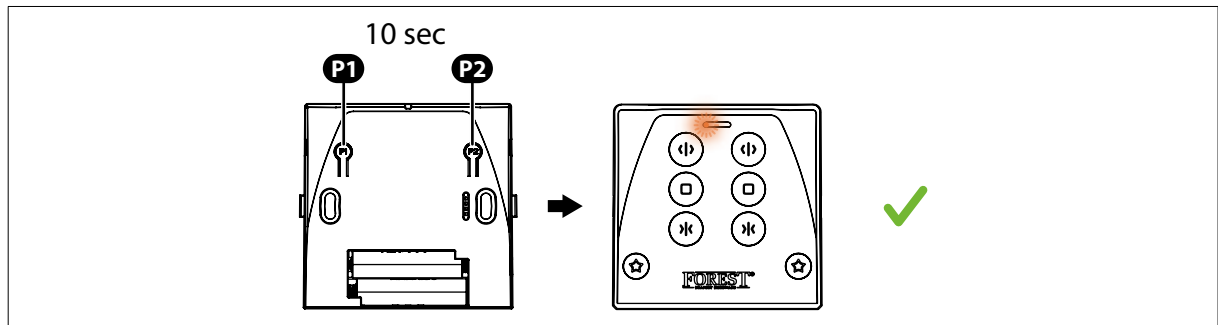

Repeat the steps of activating the child lock / hotel lock to deactivate the child lock / hotel lock.

EN

## 7. Troubleshooting

Problem	Possible cause	Possible solution
The LED indicator flashes orange when a button is pressed.	The batteries are almost empty.	Replace the batteries.
The product does not work.	The product is not paired correctly.	Follow the instructions in chapter Pairing to pair the product to the curtain motors.
	Make sure the batteries are inserted correctly and are not empty.	Replace the batteries.
	The product does not work with your curtain motor.	The product only works with Forest Shuttle motors, Forest tubular motos with internal receiver, and Forest LED systems with RF receiver. Make sure your curtain motor is compatible with the product.
My curtain or tubular motor does not have Forest Link Protocol, and the response is very slow.	The product needs to be set to the original RF protocol.	Remove the batteries. Press and hold the Stop button and reinstall the batteries. The LED indicator flashes once. Follow the instructions in chapter Pairing to pair the product to the curtain motors. The motors always require re-pairing to the remote.

If the solutions above did not solve your problem, please contact the store where you bought the Forest product.

EN

## 8. Conformity

	FCC Regulations
---	-----------------

This device complies with part 15 of the FSS Rules. Operations is subject to the following conditions:

1. This device may not cause harmful interference, and
2. this device must accept any interference received, including interference that may cause undesired operation.

EN

Note: This equipment has been tested and found to comply with the limits for a Class B digital device, pursuant to Part 15 of the FCC Rules. These limits are designed to provide reasonable protection against harmful interference in a residential installation.

This equipment generates, uses and can radiate radio frequency energy and, if not installed and used in accordance with the instructions, may cause harmful interference to radio communications. However, there is no guarantee that interference will not occur in a particular installation.

If this equipment does cause harmful interference to radio or television reception, which can be determined by turning the equipment off and on, the user is encouraged to try to correct the interference by one or more of the following measures:

- Reorient or relocate the receiving antenna.
- Increase the separation between the equipment and receiver.
- Connect the equipment into an outlet on a circuit different from that to which the receiver is connected.
- Consult the dealer or an experienced radio/TV technician for help.

### CAUTION

Any Changes or modifications not expressly approved by the party responsible for compliance could void the user's authority to operate the equipment.

	Forest Group (Netherlands) B.V. hereby declares that the product complies with the requirements of Directive 2014/53/EU.
---	--

## 9. Liability

Forest Group does not assume liability for resulting damages to persons, animals and/or property, defects, labour on location, service calls, reinstallation or expenses involved shipping, packing or returning goods, if the product has been modified in any way or damaged by improper use or failure to observe these operating instructions. In such situation, the right to any form of warranty, service and reimbursement of expenses shall cease.

## 10. Recycling

	Do not dispose of the product with household waste. Ensure that you return it to a collection point or depot for recycling purposes.
---	--

EN

# 11. Declaration of conformity



## EU Declaration of Conformity

Hereby we, the undersigned:

Manufacturer: Forest Group Nederland B.V.  
Address; city, Country: Teugseweg 42, 7418 AM Deventer, The Netherlands  
Telephone number: +31 0570 622 850

Declare that this DoC is issued under our sole responsibility and that this product is:

Product description: Wireless Wallswitch  
Type designation(s): Easytouch wireless wallswitch model 520108x002 (x is color version)  
Trademark: Forest

The object is in conformity with the relevant Union harmonization legislation:

<input checked="" type="checkbox"/>	Radio Equipment Directive – 2014/53/EU	<input checked="" type="checkbox"/>	Article 3.2
<input checked="" type="checkbox"/>	Article 3.1(a)		
	EN IEC 62368-1:2020 + A11:2020		ETSI EN 300 220-1 V3.1.1 (2017-02)
			ETSI EN 300-220-2 V3.1.1 (2017-02)
	EN 62479:2010		
<input checked="" type="checkbox"/>	Article 3.1(b)		
	EN 301 489-1 V2.2.3 (2019-11) / EN 301 489-3 V2.3.2 (2023-01)		
	EN 55032:2015 + A11:2020 + A1:2020 / EN 55035:2017 + A11:2020		
<input checked="" type="checkbox"/>	RoHS directive – 2011/65/EU + amendment (EU) 2015/863		

Signed for and on behalf of:

Place: Deventer                      Name: A.G. ten Have  
Date: 14-10-2025                      Function: Head R&D

Signature:

EN

## **FOREST WORLDWIDE**

### **FOREST GROUP (NEDERLAND) B.V.**

Deventer, The Netherlands  
[www.forestgroup.com](http://www.forestgroup.com)

### **FOREST DRAPERY HARDWARE UK LIMITED**

Rochdale, United Kingdom  
[www.forestgroup.co.uk](http://www.forestgroup.co.uk)

### **FOREST GROUP POLSKA SP. Z O.O.**

Warszawa, Poland  
[www.forestpolska.com](http://www.forestpolska.com)

### **FOREST GROUP BULGARIA EOOD**

Sofia City, Bulgaria  
[www.forestgroup.bg](http://www.forestgroup.bg)

### **FOREST DRAPERY HARDWARE USA**

Cartersville, United States  
[www.forestdh.com](http://www.forestdh.com)

### **FOREST GROUP MIDDLE-EAST**

Dubai, United Arab Emirates  
[www.forestgroupme.com](http://www.forestgroupme.com)

### **FOREST GROUP CHINA LTD**

Shanghai, China  
[www.forestgroupchina.com](http://www.forestgroupchina.com)

EN